



NUMBER: 05-002-06

GROUP: Brakes

DATE: May 10, 2006

This bulletin is supplied as technical information only and is not an authorization for repair. No part of this publication may be reproduced, stored in a retrieval system, or transmitted, in any form or by any means, electronic, mechanical, photocopying, or otherwise, without written permission of DaimlerChrysler Corporation.

THIS BULLETIN SUPERSEDES TECHNICAL SERVICE BULLETIN 05-004-05 REV. A, DATED NOVEMBER 8, 2005, WHICH SHOULD BE REMOVED FROM YOUR FILES. ALL REVISIONS ARE HIGHLIGHTED WITH **ASTERISKS**** AND INCLUDES AN APPLICABILITY DATE AND AN ADDITIONAL STEP IN THE REPAIR PROCEDURE.**

SUBJECT:

Shudder While Braking

OVERVIEW:

This bulletin involves replacing the rear brake shoes and, if necessary, the axle shafts and refacing the front brake rotors.

MODELS:

2005 - 2006 (ND) Dakota

NOTE: **This bulletin applies to vehicles built on or before January 31, 2006 (MDH 0131XX).******

SYMPTOM/CONDITION:

A vibration or shudder in the brake pedal when the brakes are applied at highway speeds.

DIAGNOSIS:

PARTS REQUIRED:

Qty.	Part No.	Description
1	05191790AA	Shoe Kit
1	04796269	Brake Lubricant 1 tube will service 6 vehicles
1	J8126688	Brake Grease 1 tube will service 6 vehicles
AR (1)	52114885AA	Axle - Left 8 1/4 Rear Axle
AR (1)	52114886AA	Axle - Right 8 1/4 Rear Axle



Stick with the Specialists™

SPECIAL TOOLS/EQUIPMENT REQUIRED:

	ProCut	Hunter
One of the Following DaimlerChrysler Approved On Car Disc Rotor Lathes:	PC-610, PC-CHRYSLER, PC-TRUCK, PC-CROSTRUCK, PC-PFMTRUCK, PC-PFMCHRYSLER, PC-PFM900, PC-PFMCHRYSLER-95, PC-PFMTRUCK-95, PC-PFM900-95, PC-PFM90.2, PC-PFM90.4, PC-PFM90	H-OCL360, H-OCL360-LT-PRO, H-OCL360-LT-PSE, H-OCL360A, H-OCL360A-LT-PRO, H-OCL360A-LT-PSE, H-OCL360S, H-OCL360S-LT-PRO, H-OCL360S-LT-PSE, H-OCL400, H-OCL400-LT-PRO

REPAIR PROCEDURE:

1. Operate and inspect the parking brake system to assure that it is functioning properly. Refer to the detailed service information available in TechCONNECT, under: Service Info, 5 - Brakes, Parking Brake
2. Remove both rear wheel and tire assemblies.
3. Remove clip nuts securing brake drum to wheel studs.
4. Remove drum. If drum is difficult to remove, remove rear plug from access hole in support plate. Back-off self adjusting by inserting a thin screwdriver into access hole and push lever away from adjuster star wheel. Then insert an adjuster tool into brake adjusting hole rotate adjuster star wheel to retract brake shoes.
5. ****Is the vehicle equipped with an 8.25 in. rear axle (sales code DRA)?**
 - a. Yes >> go to [Step #6](#).
 - b. No >> go to [Step #8](#).**
6. Inspect the axle flange on the axle shafts. Axles must have an "M" stamped into the flange as shown ([Fig. 1](#)). **Does the axle shafts have an "M" stamped into the flange?**
 - a. Yes >> go to [Step #8](#).
 - b. No >> go to [Step #7](#).

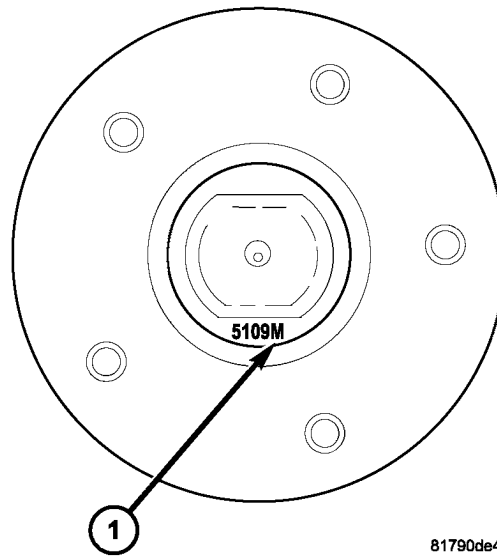
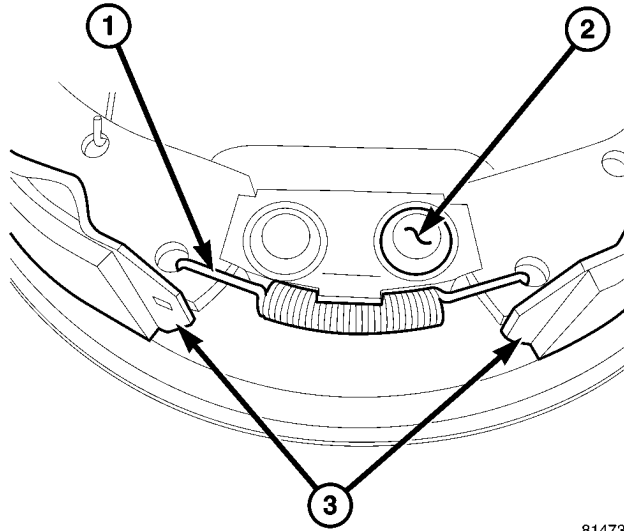

Fig. 1 AXLE IDENTIFICATION

-
7. Replace both axle shafts. Replace 8.25 axle shafts with p/n's 52114885AA and 52114886AA. Refer to the detailed service information available in TechCONNECT, under: Service Info, 3 - Differential & Driveline, Rear Axle, Axle Shafts, Removal and Installation.
 8. Install new rear brake assembly kits as follows.

NOTE: The shoe kit comes assembled and is designed to be installed as an assembly, do not disassemble the shoe kit.

9. Clean the individual brake components, including the support plate and wheel cylinder exterior, with MOPAR Brake Parts Cleaner, p/n 04897150AB or 04897151AB or equivalent.
10. Disengage and remove shoe return spring from brake shoes ([Fig. 2](#)).



81473bf6

Fig. 2 RETURN SPRING

- 1 - RETURN SPRING
- 2 - BACKING PLATE
- 3 - BRAKE SHOES

-
11. Remove the shoe hold down clips and pins.
 12. Remove the parking cable from the brake parking lever.
 13. Lift the shoes and adjuster assembly off of the brake backing plate while carefully feeding the brake parking lever through the boot.
 14. Clean the backing plate and wheel cylinder piston ends with brake parts cleaner and a clean shop towel.
 15. Apply the brake lubricant, p/n 04796269, on the backing plate pads and abutments in the 8 locations shown (Fig. 3).

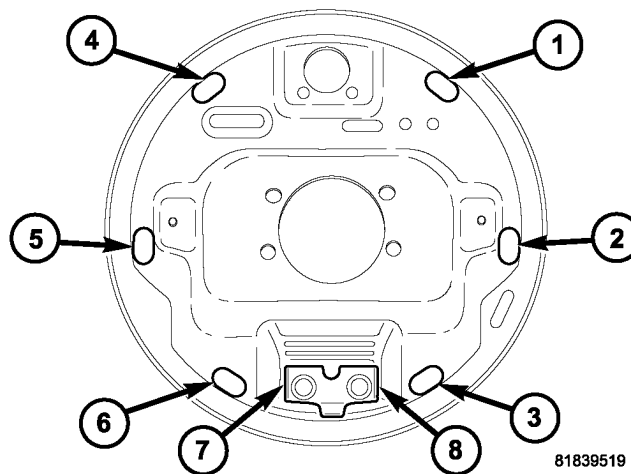

81839519

Fig. 3 BRAKE LUBRICANT APPLICATION POINTS

16. Apply a small amount of the brake grease, p/n J8126688, on the wheel cylinder piston ends (Fig. 4).

CAUTION: Do not use any other lubricant. Damage to the rubber boot may occur.

17. Install the new shoe and adjuster assembly to the backing plate.

NOTE: Carefully guide the parking brake lever through the boot to avoid damage.

18. Install the parking brake cable.

19. Install the new brake shoe hold down springs, hold down pins, lower return spring, lever pawl, and lever pawl spring provided in the kit (Fig. 4).

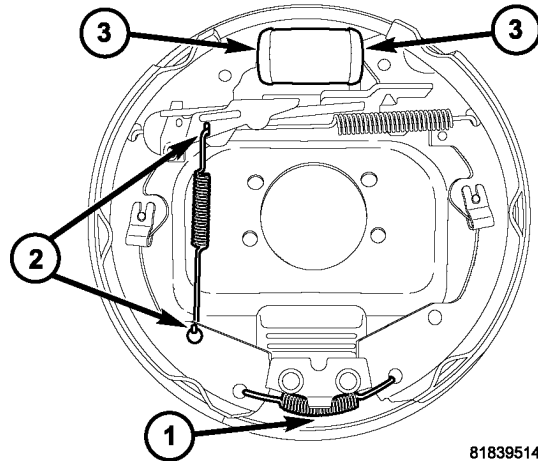

Fig. 4 COMPLETE BRAKE ASSEMBLY

- 1 - LOWER RETURN SPRING UNDER THE COVER PLATE TAB
- 2 - LEVER PAWL RETURN SPRING OVER LEVER PAWL AND UNDER SHOE
- 3 - APPLY MOPAR GREASE, P/N J8126688, BETWEEN PISTONS AND SHOES

-
- 20. Clean the axle flange and brake drum pilot with MOPAR Brake Parts Cleaner, p/n 04897150AB or 04897151AB or equivalent to remove any foreign material from the flange or pilot prevent the drum from fully seating on the axle flange.
 - 21. Adjust brake shoes to drum with brake gauge. Allow 0.025 in. clearance. Install the drums on the vehicle.
 - 22. Clean the drum and wheel pilot with MOPAR Brake Parts Cleaner, p/n 04897150AB or 04897151AB or equivalent to remove any foreign material from the drum or pilot to assure that the wheel seats on the drum and pilot. Pre-tighten the lug nuts to 7 Nm (5 ft. lbs.) to help center the wheel. Final tighten the lug nuts to 183 N-m (135 ft. lbs.).
 - 23. Repeat [Step #10](#) through [Step #22](#) on the other side of the vehicle.
 - 24. Adjust the parking brake tension. Refer to the detailed service information available in TechCONNECT, under: Service Info, 5 - Brakes, Parking Brake, Cable Tensioner, Adjustments.
 - 25. Have the front brake rotors been replaced in previous repairs?
 - a. Yes >> go to [Step #28](#).
 - b. No >> go to [Step #26](#).

26. Reface both front brake rotors with a DaimlerChrysler approved on-car brake lathe. If an on-car lathe is not available at the dealership, the rotor refacing must be sublet to a facility with an approved on car lathe.
27. Clean the rotor and wheel pilot with MOPAR Brake Parts Cleaner, p/n 04897150AB or 04897151AB or equivalent to remove any foreign material from the rotor or pilot to assure that the wheel seats on the rotor and pilot. Pre-tighten the lug nuts to 7 Nm (5 ft. lbs.) to help center the wheel. Final tighten the lug nuts to 183 N-m (135 ft. lbs.).
28. Lower the vehicle.
29. Apply pressure to the brake pedal to confirm that the brake system is functioning.
30. Check the parking brake operation.
31. Verify that the Symptom/Condition is corrected.

POLICY:

Reimbursable within the provisions of the warranty.

TIME ALLOWANCE:

Labor Operation No:	Description	Amount
05-70-06-90	Rear Brake Shoes - Replace	1.0 Hrs.
05-70-06-91	Rear Brake Shoes - Replace, Front Disc Rotors - Turn "on-Car", Both Sides	1.8 Hrs.
Related Operation No:		
03-20-01-50	Rear Axle Shafts - Replace - Both Sides	0.7 Hrs.

FAILURE CODE:

ZZ	Service Action
----	----------------